

BONECO
healthy air

TRADITION SINCE 1956
 A SWISS COMPANY

F220/F230

MANUAL

使用說明書



敬請詳閱並保存此說明書
READ AND SAVE THESE INSTRUCTIONS

使用説明 5

Instructions for use 16

使用說明書
BONECO F220/F230

目錄

技術規格	5
說明	6
裝箱單	6
分解圖與配件名稱	7
開始使用	8
操作	9
操作方式	9
角度調整	9
高度調整	9
建議擺放位置	10
使用注意事項	10
空調系統	10
引入新鮮空氣	10
多樓層空間	10
挑高室內空間	10
清潔和維護	11
安全使用說明	11
清潔外殼	11
清潔風扇葉片	11
拆裝及存放	12

技術規格

技術規格*

型號	BONECO F220 – BONECO F230	
電壓	110V ~ 60Hz	
預定功率	33 W (最大風量)	
運轉音量	58 dBA (最大風量)	
氣流	1260 m ³ /h	
風速	3.9 m/sec	
尺寸 長X寬X高	BONECO F220	375 × 375 × 850 mm (附有1個連結桿)
	BONECO F230	375 × 375 × 1210 mm(附有2個連結桿)
重量(空機)	BONECO F220	6.7kg
	BONECO F230	8.9kg

* 可能調整

說明

親愛的消費者您好：

感謝您選購BONECO 聚風循環扇，這款高效能的循環扇適合您各種需求。

低速運轉時，在炎熱的天氣裡，能讓家裡充滿舒適的微風。另一方面，如果與空調系統同時使用，強勁的風力可充分循環室內空氣達到快速降溫的效果。

在研發BONECO聚風循環扇時，操作簡易及商品耐用是首要考量。獨特的葉片切角形狀，實現低能耗同時產生大風量，達成節能愛地球的目的。聚風循環扇美型的設計適合各式風格的裝潢，讓您一年四季都能享受BONECO聚風循環扇。

希望您享受BONECO聚風循環扇！

裝箱單

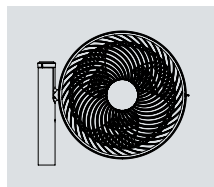

BONECO 聚風循環扇

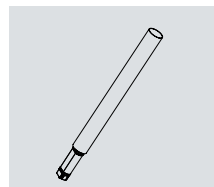

可拆式連結桿

(F220: 1×/ F230: 2×)

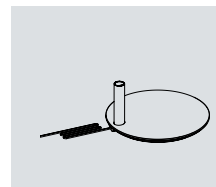

附電源線的風扇基座

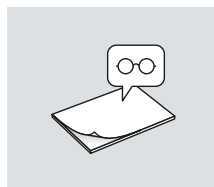

使用說明書

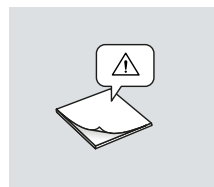

安全注意事項

分解圖和配件名稱

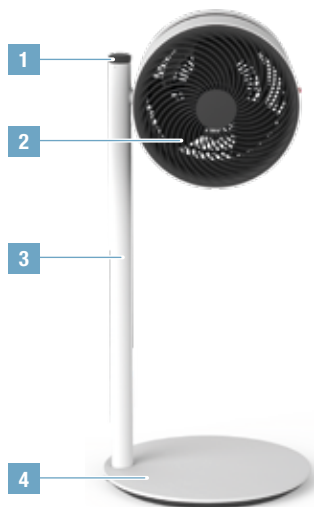

BONECO F220
聚風循環扇

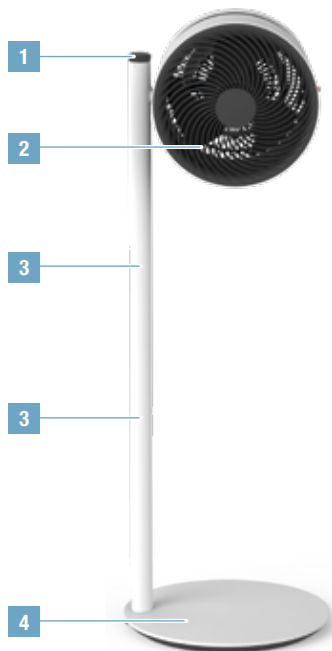

BONECO F230
聚風循環扇

1. 風速調節開關
2. 風扇
3. 可拆式連接桿
4. 附電源線底座

開始使用

1

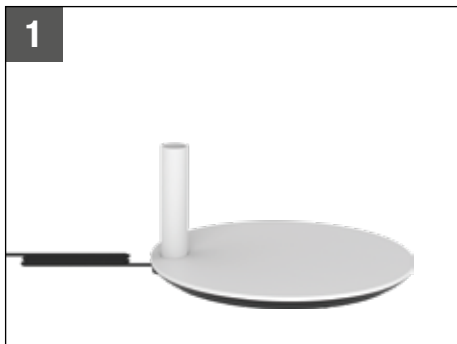

將基座放置於在平穩的地面上。

2

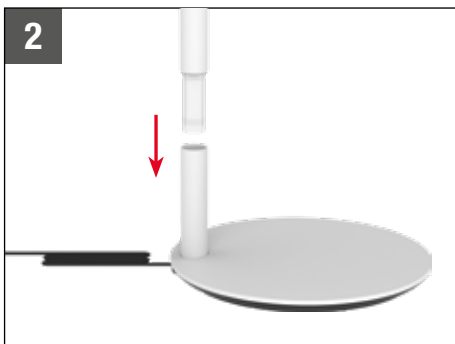

把連接桿插入基座。

3

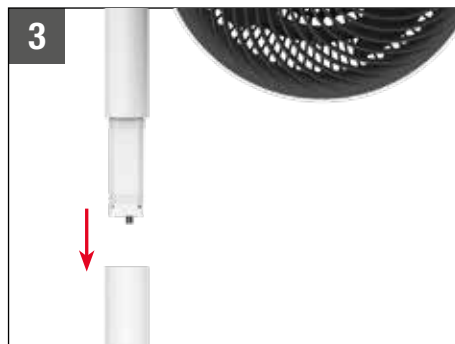

把風扇插入連接桿。

4



將電源線插入插座。

5



使用風速調節開關調整風量大小。

i BONECO F220 與BONECO F230唯一的不同是BONECO F230附有兩個連接桿。

i 您可以直接將風扇連結基座，亦可連接一個或兩個連接桿，依照您的需求安裝。

操作

操作方式

BONECO 聚風循環扇的操作方式相當簡單。

風速調節開關可 4 段式調整風速大小：
0>I>II>III>IIII。



角度調整

風扇可以手動旋轉達 270 度。

 風扇無法 360 度旋轉。

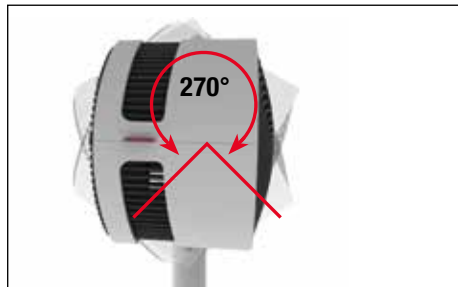

高度調整

所有的電源組件都內建於連接桿中，因此您隨時可依照需求增加或拆除連接桿來調整風扇的高度。

 基於安全的考量，一次最多可使用兩個連接桿。

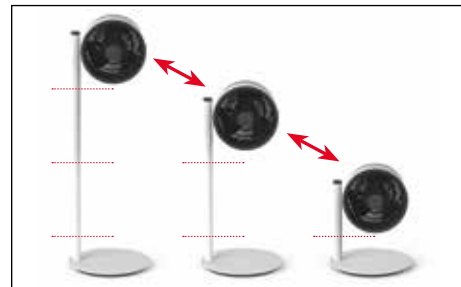

建議擺放位置

使用注意事項

BONECO聚風循環扇使用強勁的風扇，可快速循環大量的空氣。這個特性可導引空氣至特定方向，讓房間內的溫度平衡。您可以參考以下範例擺放您的聚風循環扇：

空調系統

空調以不同方向來調配溫度。使用BONECO聚風循環扇可將溫暖的空氣導向空調系統，如下圖所示：



多樓層空間

在夏季，較高的樓層容易悶熱，BONECO聚風循環扇可以將低樓層的冷空氣引導至其他較高樓層，達到均溫的效果。



引入新鮮空氣

BONECO聚風循環扇可以幫助室內空氣對流。在空氣無法充分對流時，聚風循環扇可以直接引導新鮮的空氣從窗戶進入所需的房間。



挑高室內空間

在天花板挑高的房間使用空調系統，當溫暖的空氣上昇至天花板，冷空氣會往下沉至地板上。

使用BONECO聚風循環扇直接朝上運轉能使空氣循環對流。



清潔

安全使用說明

 清潔前及拆卸護網前請將 BONECO F220/F230 循環扇的插頭拔掉，否則可能會引起觸電及致命的傷害。

 請勿使用酒精或腐蝕性清潔劑清潔。

清潔外殼

BONECO 聚風循環扇的設計無需太多維護，即使使用多年，在大多數的情況下，一條乾淨的乾布即可完成清潔。

如果有頑固污垢附著時，請在水裡加少量的洗碗精後，以濕布清潔外殼。

清潔風扇葉片

1. 將風扇旋轉向上並鬆開下方安全固定螺絲。



2. 以逆時針方向輕輕鬆開前螺旋狀網格。



3. 以順時針方向鬆開中間的葉片固定旋鈕。



4. 將風扇葉片拆下，用濕布擦拭清潔。

5. 依反方向的步驟將機器裝回

6. 鎖上螺旋狀網格的安全固定螺絲，請注意務必將安全固定螺絲安裝於原位置。



拆裝及存放

 請注意連接桿為無固定可拆式的，因此切勿直接提取風扇。如要將機器移動至另一位置時，請將所有可拆卸的配件拆開，將所有拆開的配件運至所需的位置後，再重新把機器組裝起來。

 使用原包裝存放機器較容易及方便。請將 BONECO 聚風循環扇存放於陰涼乾燥處。

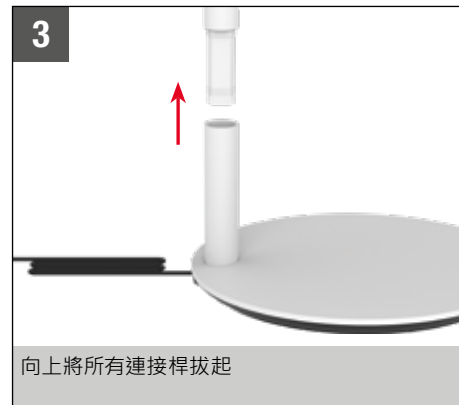

INSTRUCTIONS FOR USE BONECO F220/F230

TABLE OF CONTENTS

Technical data	5
Introduction	6
Items included	6
Overview and part names	7
Start-up	8
Handling	9
Handling	9
Alignment	9
Height adjustment	9
Positioning tips	10
Notes on output	10
Air-conditioning System (AC)	10
Fresh air	10
Multiple floors	10
Rooms with high ceilings	10
Cleaning	11
Safety instructions	11
Cleaning the housing	11
Cleaning the fan blades	11
Disassembly and storage	12

TECHNICAL DATA

Technical data*

Model	BONECO F220 – BONECO F230	
Power supply voltage	110 V ~ 60Hz	
Power consumption	33 W (max. level)	
Operation noise level	58 dBA (max. level)	
Air flow	1260 m ³ /h	
Air-speed	3.9 m/sec	
Dimensions L×W×H	BONECO F220	375 × 375 × 850 mm (with one connector piece)
	BONECO F230	375 × 375 × 1210 mm (with two connector pieces)
Weight (empty)	BONECO F220	6,7 kg
	BONECO F230	8,9 kg

* Subject to change

INTRODUCTION

DEAR CUSTOMER,

Congratulations on your purchase of the BONECO Air Shower Fan. These high-performance units seamlessly adapt to your needs. When set to the lower output levels, they provide a pleasant breeze in your home on hot days. On the other hand, if you use an air-conditioning system, the unit's powerful fan distributes the air throughout the room ensuring a uniform temperature.

In developing the BONECO Air Shower Fan, low maintenance and durability were of primary importance. The fan blade's one-of-a-kind shape creates a uniform air flow using minimal energy, which is also good for the environment. The elegant design harmonizes with any decorative style so that you can use your BONECO Air Shower Fan throughout the entire year.

We hope you enjoy your new BONECO Air Shower Fan!

ITEMS INCLUDED

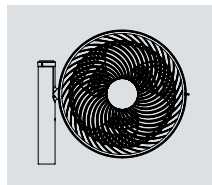

BONECO fan unit

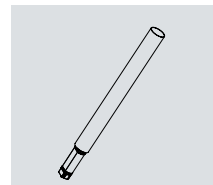

Removable connector piece
(F220: 1×/ F230: 2×)

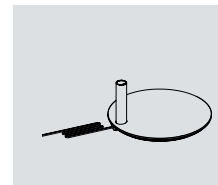

Base with power cord

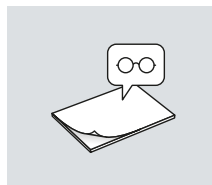

Manual



Safety instructions

OVERVIEW AND PART NAMES

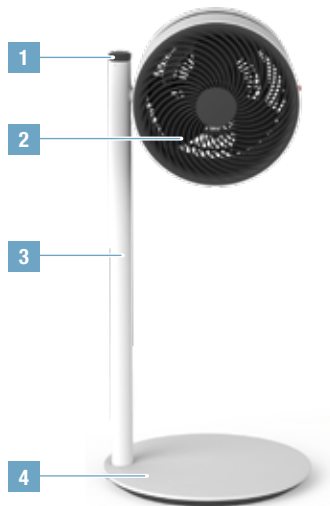

BONECO F220
Air Shower Fan

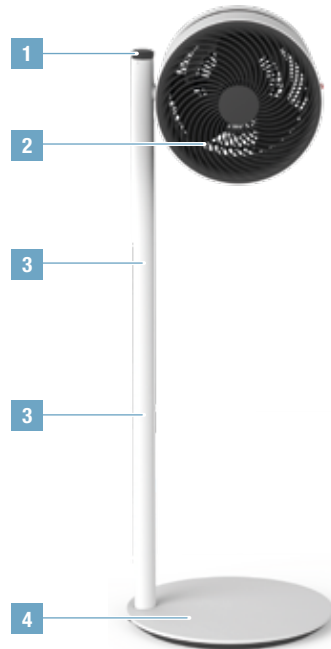

BONECO F230
Air Shower Fan

- 1 Output regulator
- 2 Fan unit
- 3 Removable connector piece
- 4 Base with power cord

START-UP

1

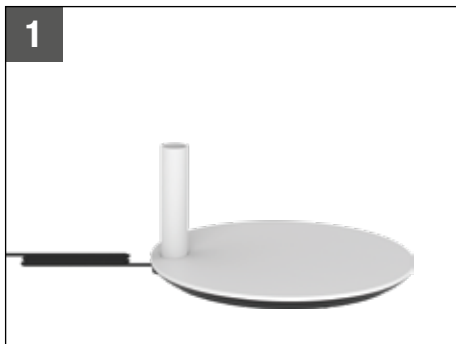

Only place the base on a stable, level surface.

2

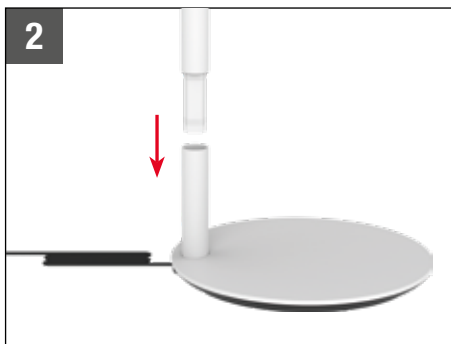

Insert the connector piece into the base.

3

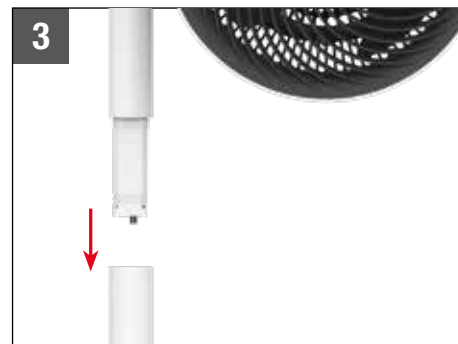

Set the fan unit onto the connector piece.

4



Plug the power cord into a power outlet.

5



Adjust the output using the control.

i BONECO F220 and BONECO F230 are only different in that the BONECO F230 includes a second connector piece.

i You can use the fan unit with one, with a second or without connector pieces. It can be customized to your needs.

HANDLING

HANDLING

All BONECO Air Shower fans are designed for easy handling. The output is adjusted in four levels using a single control: 0 > I > II > III > IIII



ALIGNMENT

The fan unit can be manually tilted 270 degrees.

 The fan unit does not rotate a full 360 degrees.

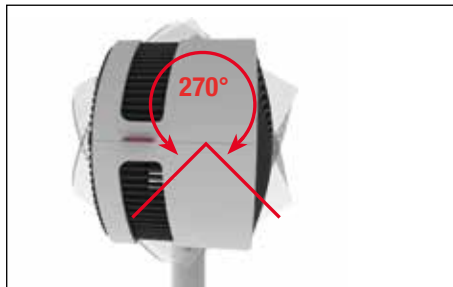

HEIGHT ADJUSTMENT

All electrical components are completely integrated in the connector. Therefore, you can adjust the height at any time by adding connector pieces or by pulling sharply to remove them.

 For safety reasons, a maximum of two connector pieces can be used at once.

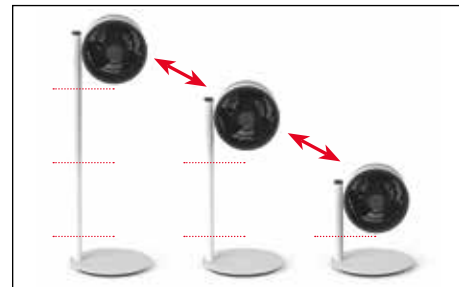

en POSITIONING TIPS

NOTES ON OUTPUT

All BONECO Air Shower fans are equipped with a high-performance fan that can move large amounts of air. Making use of this feature: Guide the air in a specific direction to achieve an uniform room climate. The following examples illustrate how to do this.

AIR-CONDITIONING SYSTEM (AC)

An air conditioner distributes temperature in various ways. Use the BONECO Air Shower Fan to move the warm air towards the air-conditioning system. This can be done directly or indirectly via air circulation, as shown in this image.



MULTIPLE FLOORS

In the summer, it can become hot and muggy on the upper floors. The powerful BONECO Air Shower Fan directs the cool air from the ground floor to multiple floors achieving a uniform temperature.



FRESH AIR

The BONECO Air Shower Fan helps you achieve better ventilation indoors. If cross-ventilation is not created, guide fresh air directly from the window into the desired room.

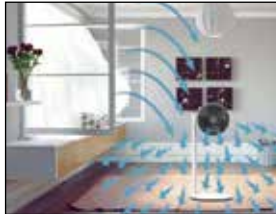

ROOMS WITH HIGH CEILINGS

In air-conditioned rooms with high ceilings, the cold air sinks to the floor while the warm air rises to the ceiling. Turn the BONECO Fan straight up for an air-shower sensation.



CLEANING

SAFETY INSTRUCTIONS

 Always unplug the BONECO Air Shower Fan before you begin cleaning! Failure to do so can result in electric shock and fatal injury!

 Do not use alcohol or corrosive cleaning agents for cleaning.

CLEANING THE HOUSING

All BONECO Air Shower fans are designed for low-maintenance operation, even after years of use. In most cases, a dry cloth can be used for cleaning.

If stubborn dirt is present, clean the housing using a damp cloth. Add a small amount of dishwashing detergent to the water.

CLEANING THE FAN BLADES

1. Tilt the fan unit upwards and loosen the safety screw.



2. Remove the front grill by turning it counterclockwise slightly.



3. Loosen the safety screw in the middle clockwise.



4. Remove the fan blades and clean them with a damp cloth.

5. Put the unit back together by following the steps in reverse order.

6. Attach the front grill with the safety screw. When doing so, pay attention to the position of the screw on the front grill.



DISASSEMBLY AND STORAGE

 Please note that the removable connector pieces are detachable. When moving the unit to a new location, disassemble the unit into the detachable parts, transport the individual parts to the desired location, and then reassemble.

 Storage is easiest and most efficient when you use the original packaging. Store the BONECO Air Shower Fan in a dry place.

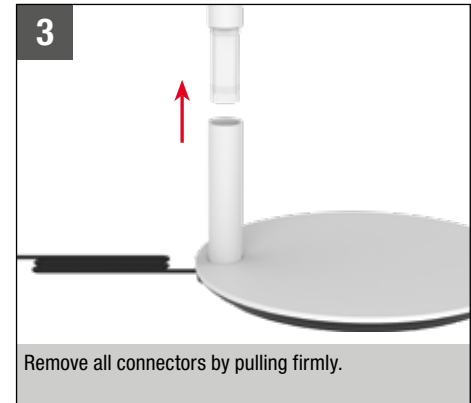
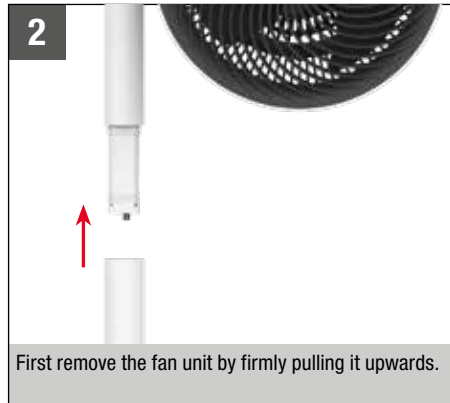
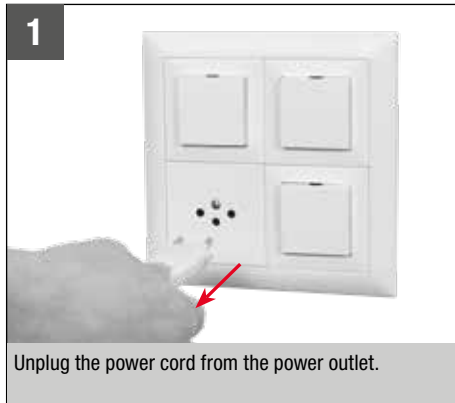



R36670
RoHS

BONECO

healthy air

www.BONECO.com.tw

台灣總代理 智淵科技股份有限公司

台北市內湖區堤頂大道一段33號6樓之1

商品的保固與我們的售後服務

感謝愛用者的支持與肯定·BONECO台灣總代理進口之所有機型
皆享有商品售後服務與期間內的商品保固。

免付費服務電話：0800-377588

服務時間:週一至週五AM9:00-PM6:00

www.boneco.com

BONECO is a registered trademark of BONECO AG, Switzerland

BONECO AG, Espenstrasse 85, 9443 Widnau, Switzerland